

CODE	MODEL	TYPE	POWER SUPPLY	SERIES
<b>398061</b>	<b>DG703</b>	<b>GAS RANGE</b>	<b>GAS</b>	<b>DRAGONE</b>

## DESCRIPTION

**ONE SIDED GAS RANGE**
**TECHNICAL DATA**

Gas power (kW)	36,0
N° of cooking zones	3x12kW
IPX Protection Grade (mm)	IPX4

**DIMENSIONS DATA**

Product dimensions (mm)	1650W x 700 P x 900 H
Net weight (kg)	145
Packaging volume (m3)	1.1

**TECHNICAL FEATURES**

Work top in AISI 304 stainless steel. Support rings for wok are in vitrified cast iron. Overfull drain pipe. Removable drip-collecting trays. Vertical flame burners in vitrified cast iron with burner cap in brass with double ring and stabilized flame (2 x 12 kW). Valve tap with pilot flame for gas burner ignition. Control panel which can be quickly removed for easy cleaning and maintenance. Adjustable AISI 304 stainless steel feet.

**ACCESSORIES(not included)**

Code	Model	Description
833507	RI-COL	ORIENT.WATER TUBE H700 0527025
445001	DK-18	BURNER 18 KW - TO BE REQUESTED WHEN ORDERING
445005	DK-12G	12 KW BURNER WITH STAINLESS STEEL GRID
825581	D-GIF	STAINLESS STEEL GRID
445012	DK3-H2O	WATER TAP KIT FOR ONE-SIDED GAS/ELECTRIC RANGE
445013	DK6-H2O	WATER TAP KIT FOR TWO-SIDED GAS/ELECTRIC RANGE
4900615	DP-55	HINGED DOOR 1/2 MODULE
4900616	DP-110	HINGED DOOR 1 MODULE
4900617	DP-165-S	SLIDING DOOR 1 MODULE
4930101	D-A55	SPLASH GUARD
4930103	D-A110	SPLASH GUARD
4930105	D-A165	SPLASH GUARD

CODE	MODEL	TYPE	POWER SUPPLY	SERIES
<b>398061</b>	<b>DG703</b>	<b>GAS RANGE</b>	<b>GAS</b>	<b>DRAGONE</b>

## DESCRIPTION

**ONE SIDED GAS RANGE**

## TECHNICAL DRAWING

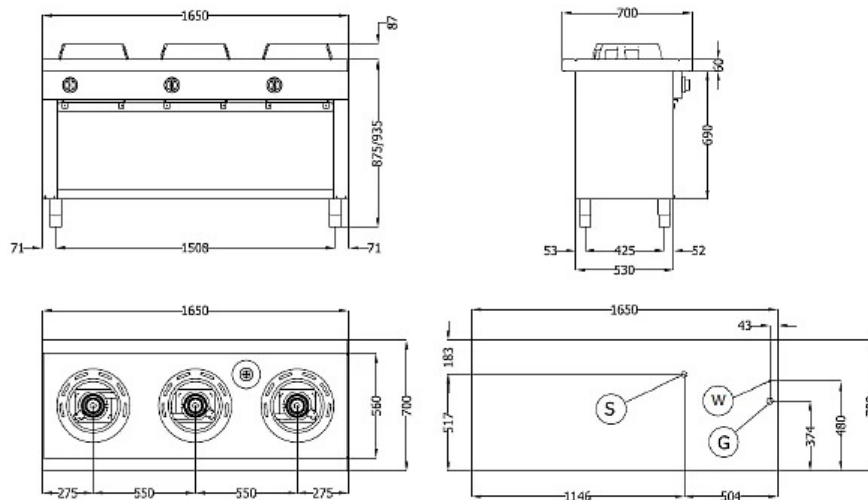
**CONNECTIONS**

G = GAS	Ø 1"
W = WATER INLET	Ø 3/4"
S = DRAIN	Ø 1/2"